

# QUICK START GUIDE



TUNE125BT



## WHAT'S IN THE BOX

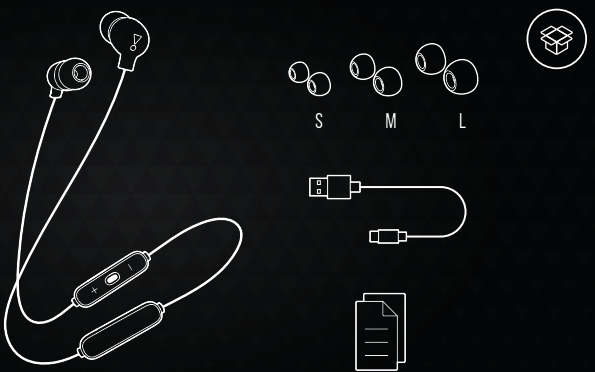

## HOW TO WEAR

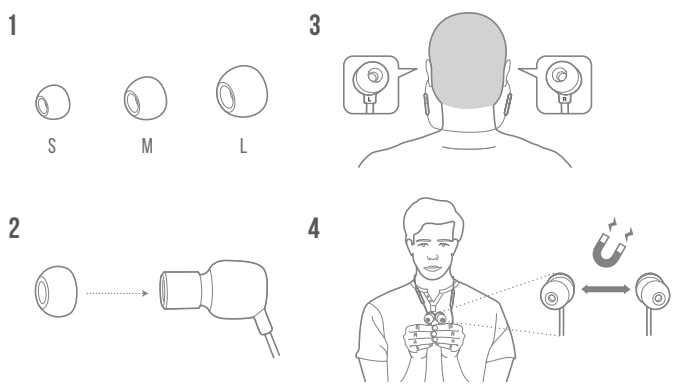

## POWER ON & CONNECT

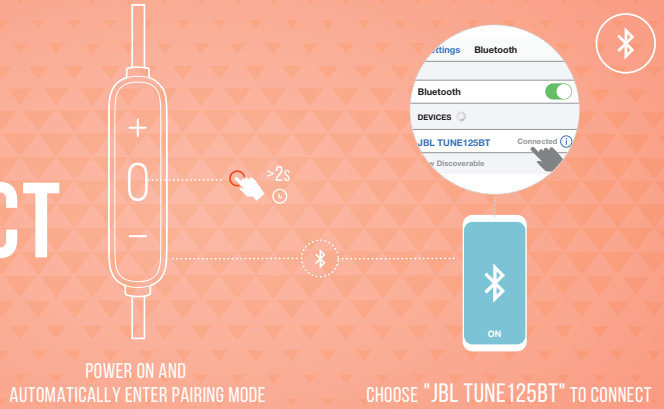

POWER ON AND AUTOMATICALLY ENTER PAIRING MODE

CHOOSE "JBL TUNE125BT" TO CONNECT

## BUTTON COMMAND

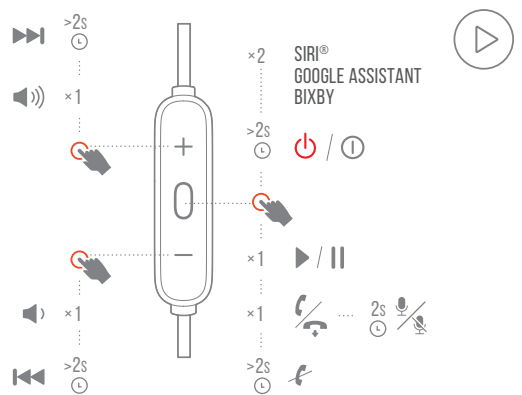

## MULTI-POINT CONNECTION

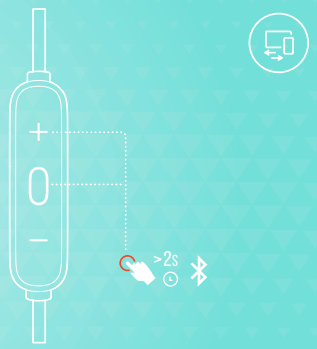

\* (MAXIMUM 2 DEVICES)

ENTER PAIRING MODE WITH THE 2<sup>ND</sup> DEVICE

- 1 TO SWITCH MUSIC SOURCE, PAUSE THE MUSIC ON THE CURRENT DEVICE AND SELECT PLAY ON THE 2<sup>ND</sup> DEVICE.
- 2 PHONE CALL WILL ALWAYS TAKE PRIORITY.
- 3 IF ONE DEVICE GOES OUT OF BLUETOOTH RANGE OR POWERS OFF, YOU MAY NEED TO MANUALLY RECONNECT THE REMAINING DEVICE.
- 4 SELECT "FORGET THIS DEVICE" ON YOUR BLUETOOTH DEVICES TO DISCONNECT MULTI-POINT.

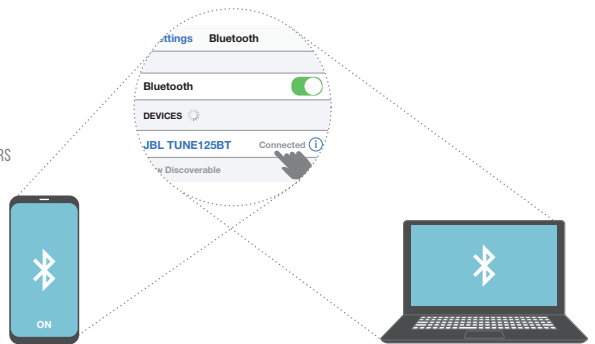

1<sup>ST</sup> BLUETOOTH DEVICE

CHOOSE "JBL TUNE125BT" TO CONNECT

2<sup>ND</sup> BLUETOOTH DEVICE

## CHARGING

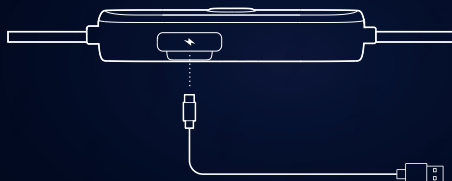

CHARGE + = 2HR

10MIN = 1H

## LED BEHAVIORS

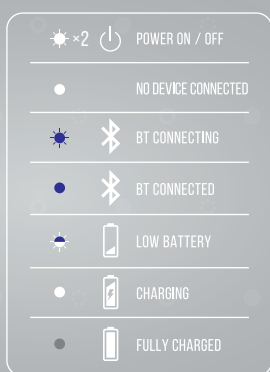

## TECH SPEC

**Model:** TUNE125BT  
**Driver Size:** 8.6 mm / 0.34" Dynamic driver  
**Power supply:** 5V --- 1 A  
**Weight:** 18.3 g / 0.04 lbs  
**Headset battery type:** Lithium-ion battery (3.7V / 130 mAh)  
**Charging time:** < 2 hrs  
**Music playtime with BT on:** up to 16 hrs  
**Frequency response:** 20 Hz – 20 kHz  
**Impedance:** 16 ohm  
**Sensitivity:** 95 dB SPL @1kHz 1mw  
**Microphone sensitivity:** -29 dBV/Pa @1kHz  
**Bluetooth version:** 5.0  
**Bluetooth profile version:** HFP 1.7, A2DP 1.3, AVRCP 1.6  
**Bluetooth transmitter frequency range:** 2.4 GHz- 2.4835 GHz  
**Bluetooth transmitted power:** < 6 dBm  
**Bluetooth transmitted modulation:** GFSK, π/4 DQPSK, 8DPSK  
**Maximum operation temperature:** 45 °C

